

FINE CONTROLS (UK) LTD



Fine Controls have been supplying process controls & instrumentation equipment since 1994, & now serves an ever expanding customer base, both in the UK & globally.

We offer a full range of valve & instrumentation products & services, with our product range representing leading technologies & brands:

Flow: Flow Meters & Transmitters, Flow Switches, Flow Control Valves & Batch Control Systems

Temperature: Temperature Probes & Thermowells, Temperature transmitters, Temperature Regulators & Temperature Displays

Level: Level Transmitters & Switches

Pressure: Pressure Gauges & Transmitters, Precision & High Pressure Regulators & I-P Converters, Volume boosters.

Precision Pneumatics: Pressure Regulators, I-P Converters, Volume Boosters, Vacuum Regulators

Valves: Solenoid & Pneumatic Valves, Control Valves & Positioners, Actuated Ball, Globe or Diaphragm Valves & Isolation Valves

Services: Repair, Calibration, Panel Build, System Design & Commissioning

A rotork® Brand
FAIRCHILD



bürkert



SIEMENS



alcon
SOLENOID VALVES

A rotork® Brand



MIDLAND-ACS
A rotork® Brand



Honeywell



Bourdon
Baumer Group



SOLDO
CONTROLS

A rotork® Brand



Fine Controls (UK) LTD, Bassendale Road, Croft Business Park,
Bromborough, Wirral, CH62 3QL UK
Tel: 0151 343 9966
Email: sales@finecontrols.com

Kit PN 16300-686

15900-461
Rev. 5
January 2009

Series 760 ValvePAC Valve Positioner

This kit contains service parts for standard temperature and high temperature Series 760 ValvePAC™ valve positioners, design levels A, B and D.

The design level is indicated by the next to last character in the model number, shown on a label inside the cover. If necessary, the design level can be determined by examining the input shaft; see the following table. Verify the design level before servicing the positioner.

DESIGN LEVEL	POSITIONER INPUT SHAFT CHARACTERISTIC
A	The input shaft has a single or double O-ring configuration, and the O-ring is nested between the shaft and the bushing.
B	The input shaft has a single O-ring configuration, and the O-ring is nested between the shaft and the housing.
D	Same as B except with universal input shaft for NAMUR, 0.5" square and linear adapters.

Kit contents are listed below. Refer to the Installation and Service Instruction for the positioner, SD760, for important Warnings and Cautions and for removal from service, installation of spare/replacement parts, calibration, and re-installation. Item numbers reference the exploded view on page 3.

KIT CONTENTS

ITEM NO.	DESCRIPTION	QUANTITY
	COMMON PARTS¹	
4	Cover Gasket, Silicone	1
19	Spool Clip	1
26	Block Manifold Gasket, Silicone/Fiberglass	1
48	Filter Screen	3
61	Lens Gasket	1
	STANDARD TEMPERATURE DESIGN A	
17	Gasket, Standard., Neoprene/Nylon (See detail on page 3.)	1
21	Diaphragm, Neoprene/Nylon	1
22	O-Ring, Neoprene (1.487 x 0.103)	1
31	O-Ring, Optional Speed Adjusters, Neoprene (0.364 x 0.070)	4
32	O-Ring, Neoprene (0.426 x 0.070)	2
	STANDARD TEMPERATURE DESIGN B, D	
17	Gasket, Standard., Neoprene/Nylon (See detail on page 3.)	1
21	Diaphragm, Neoprene/Nylon	1

¹ Common parts are used in all Design Levels and in standard and high temperature models.

ITEM NO.	DESCRIPTION	QUANTITY
22	O-Ring, Neoprene (1.487 x 0.103)	1
31	O-Ring, Optional Speed Adjusters, Neoprene (0.364 x 0.070)	4
32	O-Ring, Neoprene (0.421 x 0.139)	1
	HIGH TEMPERATURE DESIGN A	
17	Gasket, Viton®/Nomex® (See detail on page 3.)	1
21	Diaphragm, Viton/Nomex	1
22	O-Ring, Silicone (1.487 x 0.103)	1
31	O-Ring, Optional Speed Adjusters, Silicone (0.364 x 0.070)	4
32	O-Ring, Silicone (0.426 x 0.070)	2
	HIGH TEMPERATURE DESIGN B, D	
17	Gasket, Viton/Nomex (See detail on page 3.)	1
21	Diaphragm, Viton/Nomex	1
22	O-Ring, Silicone (1.487 x 0.103)	1
31	O-Ring, Optional Speed Adjusters, Silicone (0.364 x 0.070)	4
32	O-Ring, Silicone (0.421 x 0.139)	1

Calibrate the positioner after installing replacement parts.

Parts available for field installation are listed in the above parts list(s). Other parts shown in the parts drawing(s) are not available for field installation. Dimensions are in inches unless otherwise indicated.

For the location of your local Siemens representative, visit the Siemens Process Instrumentation product support page at <http://www2.sea.siemens.com/Products/Process-Instrumentation/Support/Customer-Support.htm>.

For technical support, refer to the following table.

Technical Support	
Online Support Request	http://www.siemens.com/automation/support-request
Telephone	1 800 333 7421
Hours of Operation	8 a.m. to 4:45 p.m. eastern time, Monday through Friday (except holidays)
Technical Publications in PDF	http://www2.sea.siemens.com/Products/Process-Instrumentation/Support/PI-User-Manuals.htm then click the product line (e.g. Control Solutions)
Public Internet Site	http://www2.sea.siemens.com/Products/Process-Instrumentation
Repair Service	1 800 365 8766 extension 3187 (for warranty and non-warranty service)

ValvePAC is a trademark of Siemens Energy & Automation, Inc. Viton® is a registered trademark of DuPont Performance Elastomers. Nomex is a trademark of E. I. du Pont de Nemours and Company. All product designations may be trademarks or product names of Siemens Energy & Automation, Inc. or other supplier companies whose use by third parties for their own purposes could violate the rights of the owners.

Siemens Energy & Automation, Inc. assumes no liability for errors or omissions in this and any attached documents or for the application and use of information included in this and any attached documents. The information herein is subject to change without notice.

Procedures in this document have been reviewed for compliance with applicable approval agency requirements and are considered sound practice. Neither Siemens Energy & Automation, Inc. nor these agencies are responsible for product uses not included in the approval certification(s) or for repairs or modifications made by the user.

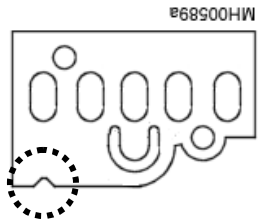

MH00589a

Detail: High temperature Viton/Nomex Spool Block Gasket is identified by V-notch or color dot and cinnamon scent.

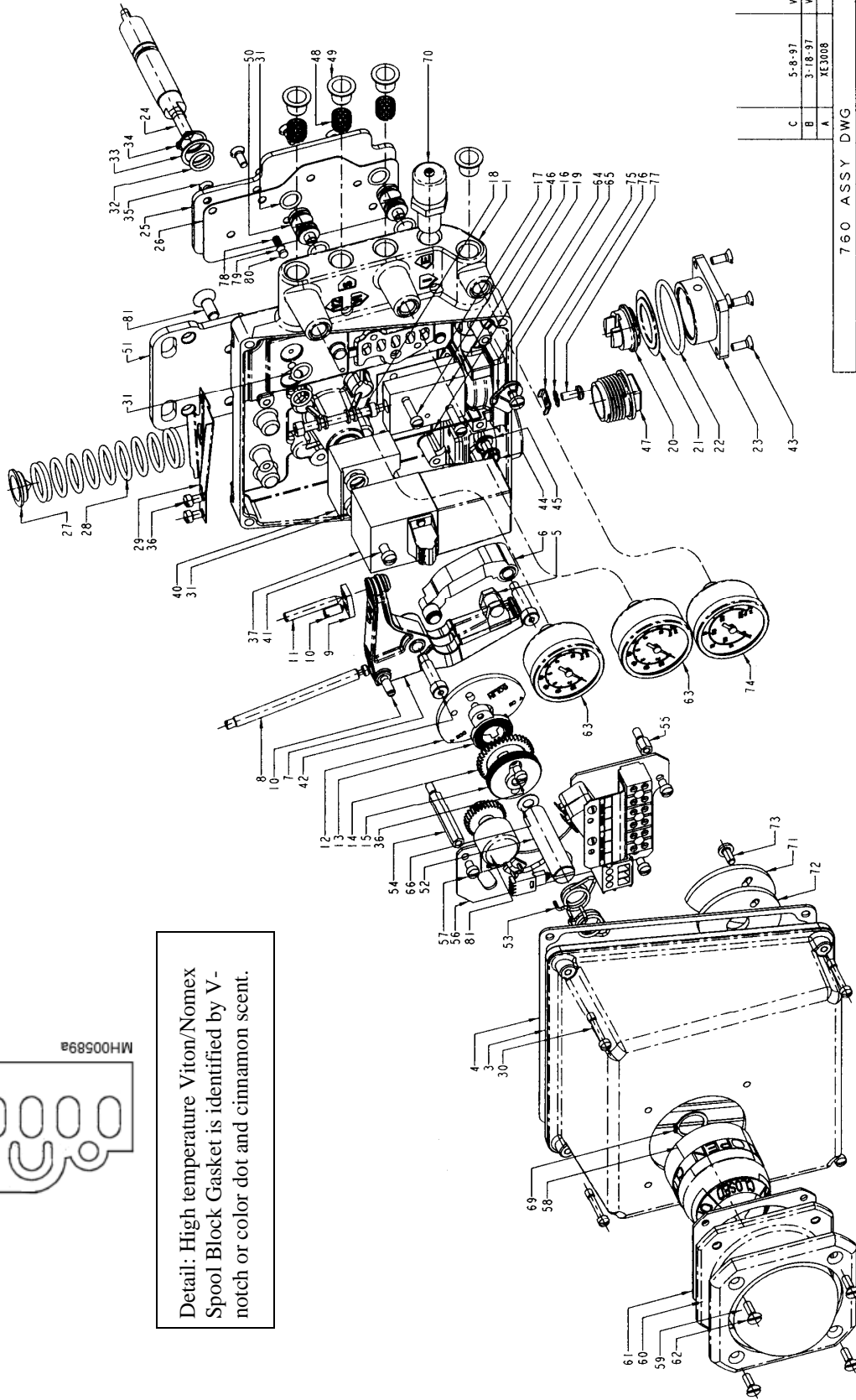

C	5-8-97	VDB
B	3-18-97	VDB
A	XE300B	

760 ASSY DWG

VDB	3-17-97	1/2X	16300-125
-----	---------	------	-----------