

# FINE CONTROLS (UK) LTD



Fine Controls have been supplying process controls & instrumentation equipment since 1994, & now serves an ever expanding customer base, both in the UK & globally.

We offer a full range of valve & instrumentation products & services, with our product range representing leading technologies & brands:

**Flow:** Flow Meters & Transmitters, Flow Switches, Flow Control Valves & Batch Control Systems

**Temperature:** Temperature Probes & Thermowells, Temperature transmitters, Temperature Regulators & Temperature Displays

**Level:** Level Transmitters & Switches

**Pressure:** Pressure Gauges & Transmitters, Precision & High Pressure Regulators & I-P Converters, Volume boosters.

**Precision Pneumatics:** Pressure Regulators, I-P Converters, Volume Boosters, Vacuum Regulators

**Valves:** Solenoid & Pneumatic Valves, Control Valves & Positioners, Actuated Ball, Globe or Diaphragm Valves & Isolation Valves

**Services:** Repair, Calibration, Panel Build, System Design & Commissioning

 A rotork® Brand  
**FAIRCHILD**



**bürkert**



**SIEMENS**



**alcon**  
SOLENOID VALVES

A rotork® Brand



**MIDLAND-ACS**  
A rotork® Brand



**Honeywell**



 **Bourdon**  
Baumer Group



**SOLDO**  
CONTROLS

A rotork® Brand



Fine Controls (UK) LTD, Bassendale Road, Croft Business Park,  
Bromborough, Wirral, CH62 3QL UK  
Tel: 0151 343 9966  
Email: sales@finecontrols.com



**BOURDON**  
The Original by Baumer

EN-  
837-3



### Main Features

- Low pressure measurements
- Class 1.6 according to EN 837-3
- Wetted parts Stainless steel (MTX5) or Brass (MTA5)
- For non corrosive (MTA5) and corrosive gases (MTX5)

### Applications

- Laboratory & Medical
- Machinery

### Technical Data

Nominal size	100 mm
Measurement ranges	0 ... 16 to 0 ... 600 mbar and corresponding vacuum and compound pressure ranges
Pressure limitation	Steady : 75% of full scale value Fluctuating : 65% of full scale value Short time : 100% of full scale value
Accuracy	Class 1.6 (according EN837-3)
Protection rating (EN 60529)	IP 44 (Type B-F-E) IP 33 (Type A-D)
Process Connection	MTA5 : Brass MTX5 : Stainless steel
Capsule	Stainless steel 1.4404 (AISI 316L)
Case	Stainless steel 1.4301 (AISI 304)
Movement	Brass
Front flange	ABS, black (for type B)
Window	Polycarbonate, snap-fitted into the case
Dial	Aluminium, white
Pointer	Aluminium, black
Temperature	Ambient: -20...60°C Medium: -20...60°C Storage: -40...70°C
Thermal drift	± 0.4 % F.S. / 10 K (reference 20°C)
Zero adjustment	± 10 % of full scale value Adjustment screw accessible on the front side after removing of the window

## Dimensions - Types of mounting

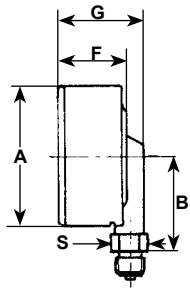

Type D

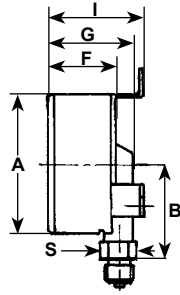

Type A

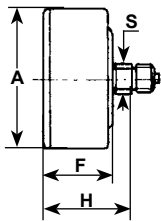
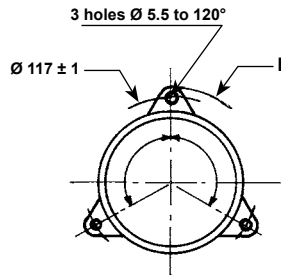

Type F

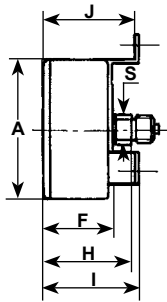

Type E

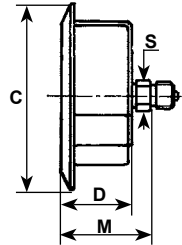

Type B

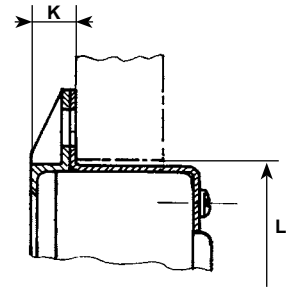

mm	A	B	C	D	E	F	G	H	I	J	K	L	M	S
<b>NS 100</b>	99	66	132	34.5	130	33.5	40.5	49.5	53.5	52.5	8.5	101	51	23

Weight  
0.350 kg

## Pressure ranges

Code	Ranges mbar
N50	-16 ... 0 <sup>1)</sup>
N51	-25 ... 0
N52	-40 ... 0
N53	-60 ... 0
N54	-100 ... 0
N55	-160 ... 0
N56	-250 ... 0
N57	-400 ... 0
N58	-600 ... 0

Code	Ranges mbar
N04	0 ... 16 <sup>1)</sup>
N05	0 ... 25
N06	0 ... 40
N07	0 ... 60
N08	0 ... 100
N09	0 ... 160
N10	0 ... 250
N11	0 ... 400
N12	0 ... 600

Code	Ranges mbar
N61	-6 ... 10 <sup>1)</sup>
N62	-10 ... 16
N63	-16 ... 25
N64	-25 ... 40
N65	-40 ... 60
N66	-60 ... 100
N67	-100 ... 160
N68	-160 ... 250
N69	-250 ... 400

<sup>1)</sup> Graduation 180°, accuracy class 2.5

